

IS 2160 ECO

Motion Detector for the Wall



- Attractively priced infrared wall sensor
- Watches over entrances, small properties etc.
- Max. reach: 12 m
- Angle of coverage: 160°
- Angle of aperture: 40°

Less is more: the IS 2160 ECO

The attractively priced IS 2160 ECO is ideal for use in smaller-type properties and at entrances. With this model, we offer our customers a sound, quality motion detector from European production. It reliably watches over areas as large as 170 m². The multi-lens divides its detection zone into 260 switching zones and 5 levels. With a reach of up to 12 metres, an angle of coverage of 160° and an angle of aperture of 40°, it provides high-quality technical features. At 600 watts, its overall switching capacity is matched to demand. Both light 'ON' time and twilight response threshold can be selected to suit individual requirements. Benefiting from outstanding, high-quality technology, the IS 2160 ECO from STEINEL Professional takes care of smaller-type lighting tasks with familiar precision and reliability.

Detection zone

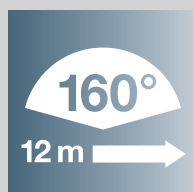

Max. reach:
12 m tangentially
Angle of coverage: 160°
Angle of aperture: 40°

Setting capabilities

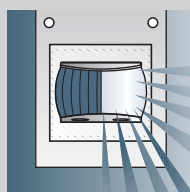

Shroud foils:
limit the angle of
coverage to suit
requirements



Detection zone:
exact adjustment by
tilting and turning

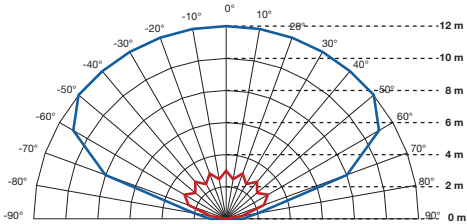
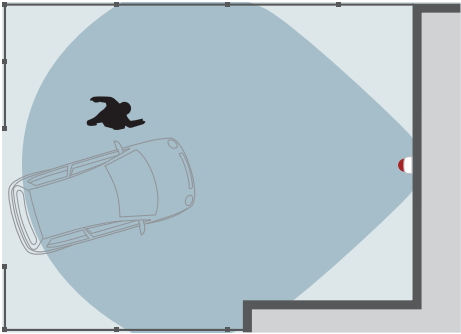

IS 2160 ECO reach, mounting height 1.8 m
(blue = tangential walking direction, red = radial walking direction)



IS 2160 ECO

EAN	black white	4007841 605919 4007841 606015
Dimensions (w x h x d)	113 x 78 x 73 mm	
Output	- 600 W max. (resistive load, e.g. filament bulb), - 500 W max. (uncorrected, inductive, cos φ = 0.5, e.g. fluorescent lamps) - 500 W max. (series corrected) - 500 W max. (parallel corrected, with C ≤ 45.6 µF) - electronic ballasts, capacitive, e.g. low-energy lamps, max. of 6 each. C ≤ 132 µF	
Voltage	230 – 240 V/50 Hz	
Detection angle	160°	
Reach	12 m max.	
Adjustment range	40° horizontally, 70° vertically	
Sensor system	5 detection levels, 260 switching zones	
Time setting	8 sec. – 35 min.	
Twilight setting	2 – 2000 lux	
Manual override	–	
IP rating	IP 54	
Protection class	II	
Ambient temperature	-20° to +50° C	

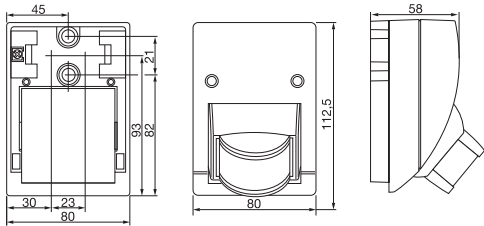

Motion Detectors

Presence Detectors

SensorLights

Sensor-Switched Floodlights

Wireless Sensor Systems

Support, Service