

# Wireless push button

WPH-01



Wireless push button that enables wireless control of one or more products from Plejd. The product is easily installed using double-sided tape, screws, or attached to a standard appliance box. Settings can be easily configured with the Plejd app.

- Choose between single and double momentary rocker switches for 55 mm frames. For color options see article list.
- Direct control, multiway switching and/or control scenes.
- Estimated battery life up to 200,000 clicks or 15 years (2 x CR2032 replaceable batteries).

## Article list for Wireless push button

Compatible with Schneider Exxact white  
Compatible with Schneider Exxact anthracite  
Compatible with Elko RS/Plus white  
Compatible with Elko Plus black  
Compatible with Gira System 55 and Jung A/AS-range white

WPH-01-SW  
WPH-01-SA  
WPH-01-EW  
WPH-01-EB  
WPH-01-55W

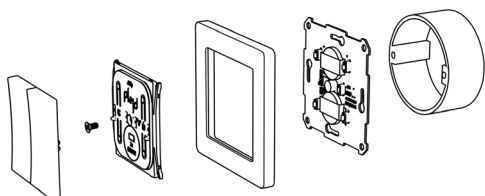

Mounting on the outside of an appliance box with screws.

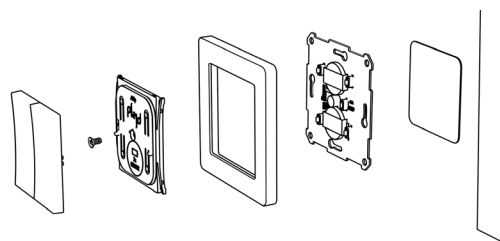

Mounting with accompanying tape on a wall.

## EXTERNAL OPERATING TEMPERATURE

-25 to +35 °C  
Non-condensing

## DIMENSIONS

71x71x20 mm  
Insert 55x55 mm

## RADIO

2.4 GHz mesh  
Bluetooth®

## RADIO RANGE

Up to 10 m indoors.

