

AU70

Name: **Junction box**

Ceiling junction box for 13/26 mm board

System Ideal

Type: AU70

EAN: 6418677332357

Description: The ceiling junction box has two screw pillars for M4 screws, e.g. for attaching lamp connectors or roof lids and screw distance is c/c 70 mm. The green adapter ring, delivered with the box, is used when board thickness is 12-13 mm. The ring is removed when the board thickness is 24-26 mm e.g. double plaster board. There are 8 fixed inlets for 20 mm conduits, and 6 have an adapter for 16 mm conduit. All inlets are equipped with a locking device in metal for reliable connection between the conduits (flexi or stiff pipe) and the box. In addition, there are two knock outs in the bottom for different inlets. Manufactured from halogen free material (IEC/61249-2-21), the box complies with the IEC/EN60670:2005 glow wire test (850 °C).

Package: 50

Unit: PCS

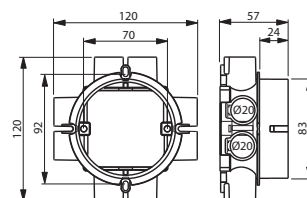

Technical specification

Dimensions

For plastic pipe Ø16/20mm

Electrical quantities

Rated voltage 400 V

thermal conditions

Operating temperature -25 ... 90 °C

ETIM

ETIM 7 EC002601 (EC002601)

ETIM 8 EC002601 (EC002601)

ETIM 7

Mounting method Flush mounted (plaster)

Shape Round

Construction type Cable junction box

Model Single

Provided with revolving ring no

Can be coupled no

Equipped with None

Diameter 92 mm

AU70

Depth	57 mm
Internal depth	53 mm
For number of electric fittings	1
Mounting switching equipment	Screwing
With screws	no
Housing feed-through by break-out opening	no
Housing feed-through by seal membrane	no
Housing feed-through by nozzle	yes
Housing feed-through by step membrane	no
For tube diameter	Other
Pipe locking	yes
Pipe locking optional	no
Inlet from the rear	yes
Number of inlets	8
Number of included spouts	8
Material	Plastic
Halogen free	yes
Surface protection	Untreated
Colour	Blue
Degree of protection (IP)	Other
Transparent cover	no
Cover attachment	Snapped on
Sealable	no
Circuit integrity	None
With screening	no
Wind proof	no
Max. conductor cross section	0 mm ²
Number of poles of the clamp	
Clamp position fixed	no
Luminaire hook mounting	no
Nozzle	None
With nail lugs	yes
Special application	None