

# AU8.73

Name: **Junction box**  
Junction box, 73 mm

Type: AU8.73

EAN: 6438199000435

Description: The AU8 junction box is 73 mm high and has eight inlets for Ø 20 conduits. Two of the Ø 20 inlets are equipped with removable reducers for adjusting them to fit Ø 16 conduits. The box also has knock-outs for 4 side inlets and 4 bottom inlets. Made of halogen free material (IEC/61249-2-21) and fulfills the requirements of the glow wire test according to the standard IEC/EN60670: 2005 (850 °C).

Package: 40

Unit: PCS

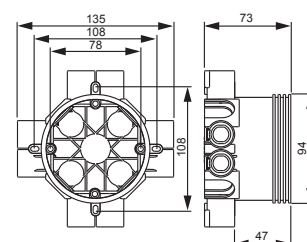

## ETIM

ETIM 7 EC002601 (EC002601)

## ETIM 6

Mounting method Flush mounted (plaster)

Shape Round

Construction type Cable junction box

Model Single

Provided with revolving ring no

Can be coupled no

Equipped with None

Diameter

Length

Width

Depth

Internal depth

For number of electric fittings 1

Mounting switching equipment Screwing

With screws no

Housing feed-through by break-out opening yes

Housing feed-through by seal membrane no

Housing feed-through by nozzle yes

Address  
P.O. Box 16  
06101 Porvoo  
FINLAND

ABB Exchange  
+358 10 22 11

Customer service  
kotimaanmyynti@fi.abb.com

Web  
<http://www.abb.fi>

Business ID  
0763403-0

# AU8.73

Housing feed-through by step membrane	no
For tubediameter	20/25 mm
Suitable for cable diameter	
Pipe locking	yes
Pipe locking optional	no
Inlet from the rear	yes
Number of inlets	8
Number of included spouts	8
Material	Plastic
Halogen free	yes
Surface protection	Untreated
Colour	White
Degree of protection (IP)	Other
Cover	None
Cover attachment	Not applicable
Sealable	no
Circuit integrity	None
With screening	no
Wind proof	no
Max. conductor cross section	0 mm <sup>2</sup>
Number of poles of the clamp	
Clamp position fixed	no
Luminaire hook mounting	no
Nozzle	None
With nail lugs	yes
Special application	