



Power and productivity
for a better world™

PRODUCT CARD

27.11.2015

AU5.2

Name: **Mounting box, branched 2-way**
Mounting box, branched 2-way

Type: AU5.2

EAN: 6410011523032

Description: The characteristics of this box are the same as the AU3.2; the difference is in the inlets. The box has 2 branch inlets for D20 conduits. There are also 3 knock-out on the side, and 2 on the bottom. Made of halogen free material (IEC/61249-2-21) and fulfills the requirements of the glow wire test according to the standard IEC/EN60670: 2005 (850 °C).

Package: 100

Unit: PCS

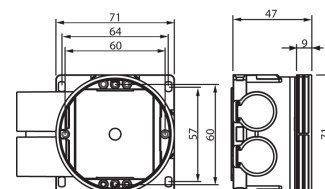

Technical specification

Dimensions

For plastic pipe Ø16/20mm

Address
P.O. Box 16
06101 Porvoo
FINLAND

ABB Exchange
+358 10 22 11

Customer service
customerservice.ABJ@fi.abb.com

Web
<http://www.abb.fi>

Business ID
0763403-0