

Relay switch insert

Operating instructions

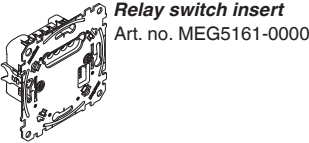

Relay switch insert
Art. no. MEG5161-0000

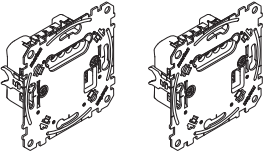
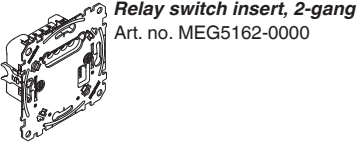

Relay switch insert, 2-gang
Art. no. MEG5162-0000

Necessary accessories

- Complete the relay switch insert with corresponding modules (see function overview).

Accessories

- PlusLink Expander (Art. no. MEG5130-0000)

For your safety



DANGER
Risk of death from electric shock.

All work on the device should only be carried out by trained and skilled electricians. Observe the country-specific regulations.



DANGER
Risk of death from electric shock.

The PlusLink carries an electrical current even when the device is switched off. Before working on the device, always disconnect it from the supply by means of the fuse in the incoming circuit. If one or more PlusLink lines are separately fused in your installation then they are not electrically isolated from one another. In this case, you should use the PlusLink Expander.



CAUTION
The device can become damaged.

The voltage differential between different phases can damage the device. All devices connected to one or more PlusLink lines must be connected to the same phase.

Getting to know the relay switch insert

You can use the relay switch insert (referred to below as the **insert**) to switch ohmic, inductive or capacitive loads per channel.

The insert also comes with one (1-gang insert) or two (2-gang insert) **PlusLink** inserts, with which you can control the channels from another location. The insert, completed with a module (see the function overview), is the receiving device and is controlled via **Plus Link (PL)** by the sending device.

Sending devices are, for instance:

- Central unit insert (completed with corresponding modules)
- Side controller Plus, 1-gang/2-gang
- Mechanical push-buttons
- External sensors

To be able to use the PlusLink, you require a separate core in your installation.



The total length of cable sections in a PL line is not allowed to exceed 100 m (when a 3-core cable is used).



CAUTION
The insert can become damaged!

- Always operate the insert in compliance with the specified technical data.
- Operate the insert only on a sinusoidal mains voltage. It can be damaged if it is used with dimmers or capacitors.

Function overview of the 1-gang-insert completed with corresponding modules

Module:	Function:
Push-button module Basic, 1-gang	<ul style="list-style-type: none">• switching on/off
Push-button module Basic, 2-gang	<ul style="list-style-type: none">• switching on/off• retrieving and saving light scenes
Push-button module Comfort, 1-gang	<ul style="list-style-type: none">• switching on/off• staircase lighting function
Push-button module Comfort, 2-gang	<ul style="list-style-type: none">• switching on/off• retrieving and saving light scenes• staircase lighting function
Push-button module Comfort Plus with IR, 1-gang	<ul style="list-style-type: none">• switching on/off• staircase lighting function• 24-hour time switch• week time switch• random function• IR function
Push-button module Comfort Plus, 2-gang	<ul style="list-style-type: none">• switching on/off• retrieving and saving light scenes• staircase lighting function• 24-hour time switch• week time switch• random function
CONNECT RF push-button module, 1-gang	<ul style="list-style-type: none">• switching on/off• switching CONNECT devices
CONNECT RF push-button module, 2-gang	<ul style="list-style-type: none">• switching on/off• switching CONNECT devices
Rotary module	<ul style="list-style-type: none">• switching on/off• retrieving and saving light scenes
ARGUS 180 flush-mounted sensor module	<ul style="list-style-type: none">• brightness dependent staircase lighting function
ARGUS 180 flush-mounted sensor module with switch	<ul style="list-style-type: none">• brightness dependent staircase lighting function• permanently switching staircase lighting on/off
ARGUS Presence 180/ 2.20 m flush-mounted sensor module	<ul style="list-style-type: none">• brightness dependent staircase lighting function
ARGUS Presence sensor module with IR	<ul style="list-style-type: none">• brightness dependent staircase lighting function• IR function
Display timer module	<ul style="list-style-type: none">• switching on/off• receiving "DCF time"
Display thermostat module	<ul style="list-style-type: none">• Solutions (see module manual)

Insert in combination with sending devices via PlusLink
(here shown with Side controller Plus)

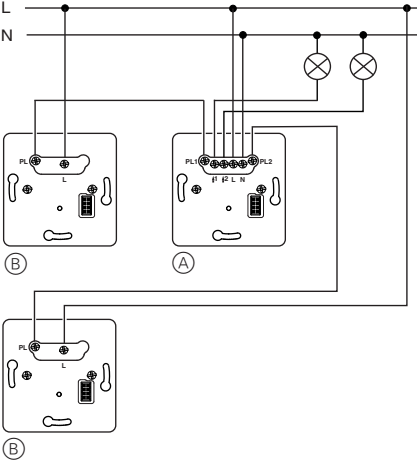

- (A) Relay switch insert, 2-gang
(B) Side controller Plus 1-gang / 2-gang (sending device)

Installing the device

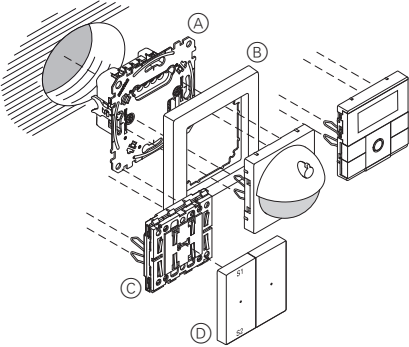

- (A) Relay switch insert, 1-gang/2-gang
(B) Frame
(C) Module (see function overview)
(D) Rockers for module

Operating the insert

i The insert is shown here in operation in combination with a push-button module. More details on how to operate the various modules can be found in the corresponding operating instructions.

Switching loads on/off (1-gang insert)

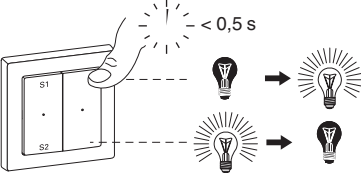

Switching loads on/off (2-gang insert)

- right button: channel 1
- left button: channel 2

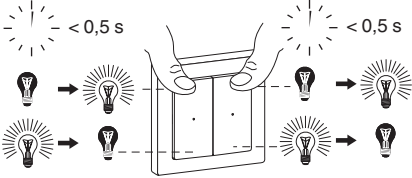

Retrieving light scenes (1-gang insert)

(only for push-button module, 2-gang)

Standard scenes

All devices are delivered from the factory with presettings for a light scene.

- S1: light on
S2: light off

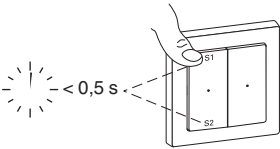

Controlling loads from another location with sending devices via PlusLink. For example:

- Central unit insert with module
- Side controller Plus, 1-gang/2-gang
- Mechanical push-button
- External sensor

Example operation 1:

When the push-button module on the central unit insert is pressed, all loads in the PL line are controlled together.

- short press on the push-button (< 0.5 s): switching on/off

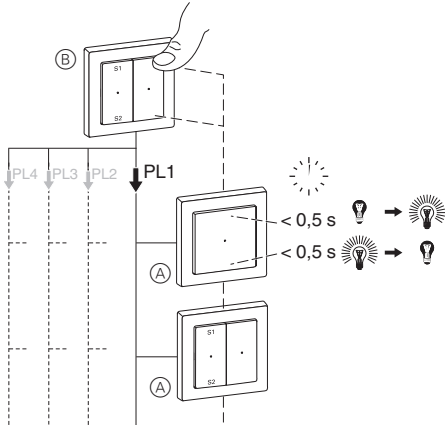

- (A) Relay switch insert in PL line 1
(B) Central unit insert with module

Example operation 2:

i When a mechanical push-button is used, we recommend connecting only one insert. With two or more inserts, simultaneous switching of the loads is no longer guaranteed.

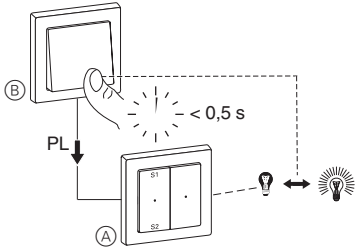

- (A) Relay switch insert
(B) Mechanical push-button

Example operation 3:

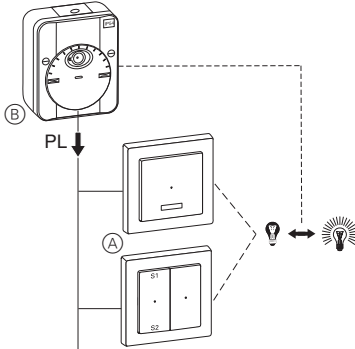

- (A) Relay switch insert with push-button module Comfort Plus, 1-gang / 2-gang
(B) Brightness sensor with wind sensor interface