

# Standard version floor boxes - sockets in horizontal position

technical characteristics

## ■ Dimensions

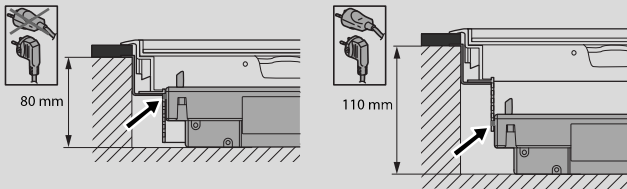
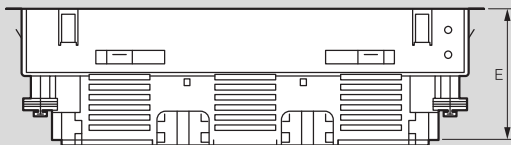
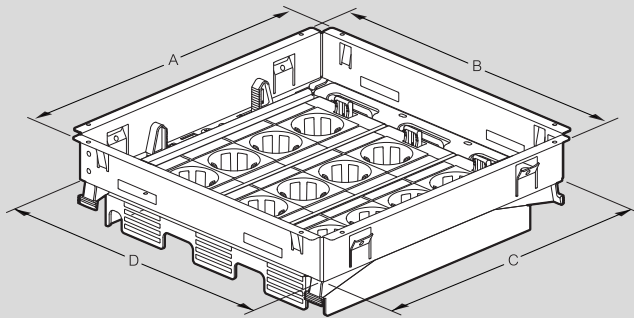

Cat.No	A (mm)	B (mm)	C (mm)	D (mm)	E (mm)
0 880 20	199		181		
0 880 21	234	282	219	264	78
0 880 22	282		264		

## ■ For installation in raised floor

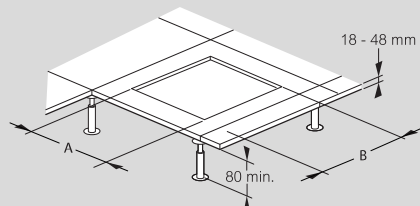

Cat.No	A (mm)	B (mm)
0 880 20	181	
0 880 21	219	264
0 880 22	264	

## ■ Installation principle in concrete floor

With auto-adjusting backbox

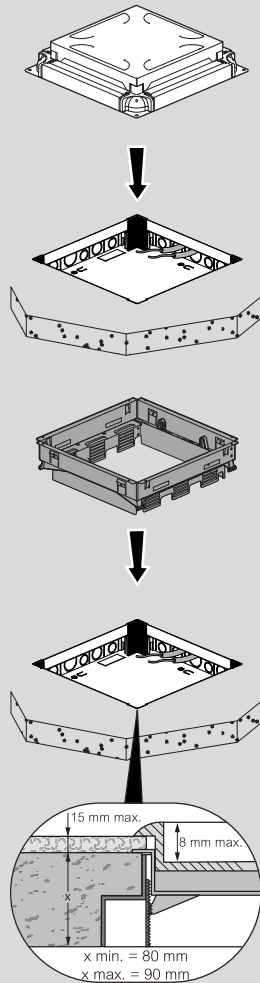

With universal adjustable backbox

