

Wireless push button

WPH-01



Elko white



Schneider white



Elko black



Schneider anthracite

Wireless push button that enables wireless control of one or more products from Plejd. The product is easily installed using double-sided tape, screws, or attached to a standard appliance box. Settings can be easily configured with the Plejd app.

- Choose between single and double momentary rocker switches for 55 mm frames. For color options see article list.
- Direct control, multiway switching and/or control scenarios.
- Estimated battery life up to 200,000 clicks or 15 years (2 x CR2032 replaceable batteries).

Article list for Wireless push button

Compatible with Schneider Exxact white
 Compatible with Schneider Exxact anthracite
 Compatible with Elko RS/Plus white
 Compatible with Elko Plus black
 Compatible with Gira System 55 and Jung A/AS-range white

WPH-01-SW
 WPH-01-SA
 WPH-01-EW
 WPH-01-EB
 WPH-01-55W

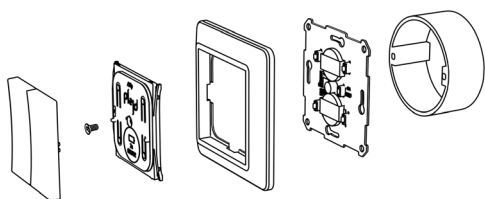

Mounting on the outside of an appliance box with screws.

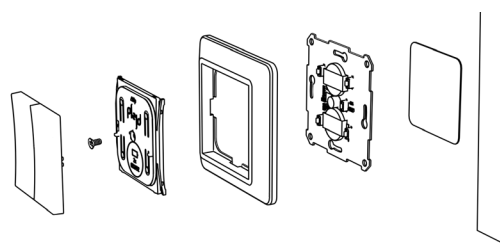

Mounting with accompanying tape on a wall.

EXTERNAL OPERATING TEMPERATURE

-25 to +35°C
 Non-condensing

DIMENSIONS

71x71x20 mm
 Insert 55x55 mm

RADIO

2.4 GHz mesh
 Bluetooth®

RADIO RANGE

Up to 10 m indoors.

COMPLIANT TO STANDARDS

RED 2014/53/EU
 EN 62368
 EN 301 489
 EN 300 328

